

FLOORPLAN SKETCH

Borrower: Edwin C H Kwan and Qi M Zhuo	File No.: 986785
Property Address: 476 36th St	Case No.:
City: Oakland	State: CA
Lender: AmeriSave Mortgage Corporation	Zip: 94609

Sketch

Appraisal Report prepared by:
United States Appraisals
Dated: March 15, 2021

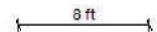
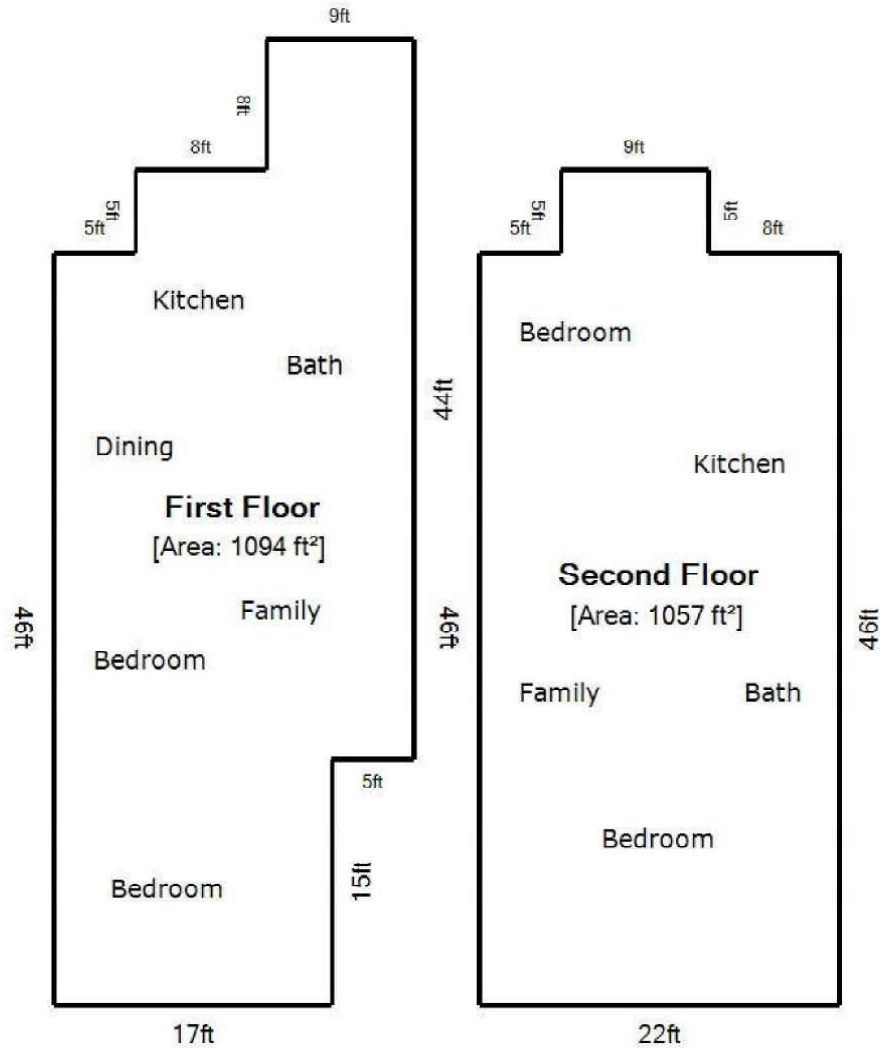

Living Area		Area Calculation			
First Floor	1093.99 ft²	First Floor			
Second Floor	1056.00 ft²	15ft x 17ft	1.00 =	255.00 ft²	x 1.00 = 1093.99 ft²
		8ft x 9ft	1.00 =	72.00 ft²	
		22ft x 31ft	1.00 =	682.00 ft²	
		5ft x 17ft	1.00 =	85.00 ft²	
		Second Floor			
		5ft x 9ft	1.00 =	45.00 ft²	x 1.00 = 1056.99 ft²
Total Living Area (rounded):	2151 ft²	22ft x 46ft	1.00 =	1011.99 ft²	